

ALINA

210

TOWER 2 UNIT 302,402,502

4 BR / 4.5 BATH
 UNIT AREA: 4,113 SF
 TERRACE AREA: 1,061 SF

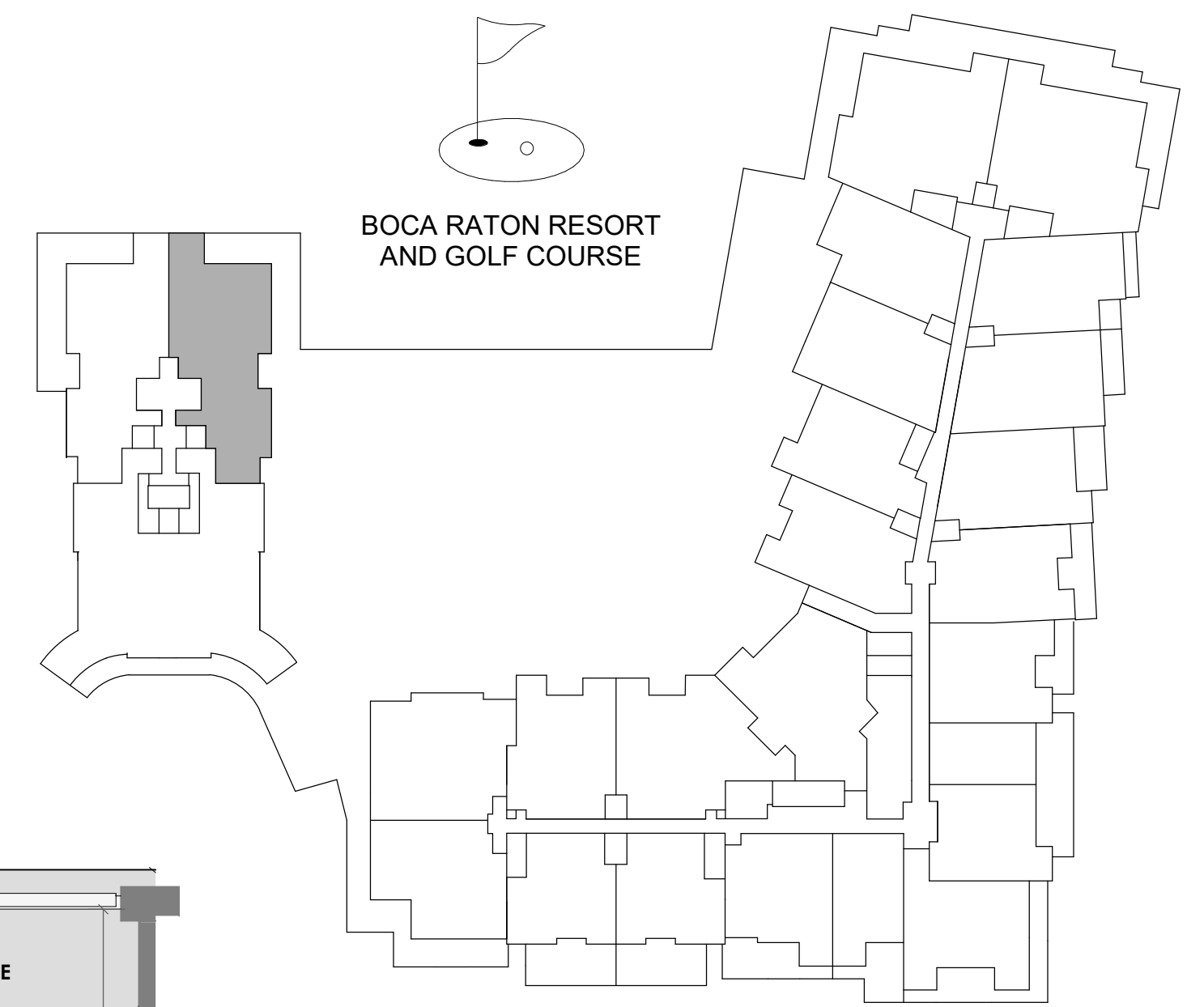

KEY PLAN
 N.T.S.



ORAL REPRESENTATIONS CANNOT BE RELIED UPON AS CORRECTLY STATING THE REPRESENTATIONS OF THE DEVELOPER. FOR CORRECT REPRESENTATIONS, REFERENCE SHOULD BE MADE TO THIS BROCHURE AND THE DOCUMENTS REQUIRED BY SECTION 718.503, FLORIDA STATUTES, TO BE FURNISHED BY A DEVELOPER TO A BUYER OR LESSEE.

THIS OFFERING IS MADE ONLY BY THE OFFERING DOCUMENTS FOR THE CONDOMINIUM AND NO STATEMENT SHOULD BE RELIED UPON IF NOT MADE IN THE OFFERING DOCUMENTS. THIS IS NOT AN OFFER TO SELL, OR SOLICITATION OF OFFERS TO BUY, CONDOMINIUM UNITS IN STATES WHERE SUCH OFFER OR SOLICITATION CANNOT BE MADE. THIS CONDOMINIUM IS BEING DEVELOPED BY EL-AD MIZNER ON THE GREEN II LLC A DELAWARE LIMITED LIABILITY COMPANY(DEVELOPER). ANY AND ALL STATEMENTS, DISCLOSURES AND/OR REPRESENTATIONS SHALL BE DEEMED MADE BY DEVELOPER AND NOT BY EL AD AND YOU AGREE TO LOOK SOLELY TO DEVELOPER (AND NOT TO EL AD AND/OR ANY OF ITS AFFILIATES) WITH RESPECT TO ANY AND ALL MATTERS RELATING TO THE MARKETING AND/OR DEVELOPMENT OF THE CONDOMINIUM AND WITH RESPECT TO THE SALES OF UNITS IN THE CONDOMINIUM. THE INFORMATION PROVIDED, INCLUDING PRICING, IS SOLELY FOR INFORMATIONAL PURPOSES, AND IS SUBJECT TO CHANGE WITHOUT NOTICE. IMAGES ARE ARTIST'S CONCEPTUAL RENDERING. This advertisement is a solicitation for the sale of units in Alina 210 Boca Raton, A Condominium: N.J. Reg. No. 22-04-0002. THE COMPLETE OFFERING TERMS FOR ALINA 210 BOCA RATON ARE IN A CPS-12 APPLICATION AVAILABLE FROM THE OFFEROR: FILE NO. CP22-0047. This advertisement is a solicitation for the sale of units in Alina 220 Boca Raton, A Condominium: NJ Reg. No. 22-04-0003. THE COMPLETE OFFERING TERMS FOR ALINA 220 BOCA RATON ARE IN A CPS-12 APPLICATION AVAILABLE FROM THE OFFEROR: FILE NO. CP22-0044.

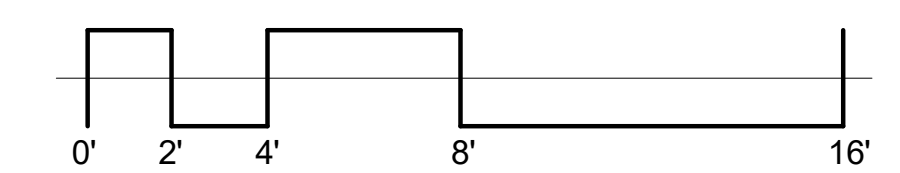

210-20 S.E. MIZNER BLVD.
 BOCA RATON, FLORIDA 33432