

MIN REQ: BFE = +5'-0" NGVD PLUS ONE FOOT = +6'-0" NGVD PROPOSED: DFE = +6'-0" NGVD = 0'-0" = DATUM = TOP OF FIRST FLOOR LIVING CONC SLAB

ALL ELEVATIONS NOTED ARE FROM THE TOP OF CONCRETE SLAB. DATUM REFERS TO THE ENCLOSED FIRST FLOOR LIVING AREA TOP OF SLAB.



**IN-SITE DESIGN GROUP LLC**  
 1544 JACKSON STREET  
 HOLLYWOOD, FL 33020  
 INSITEDESIGNGROUP.COM  
 AA22001758  
 P54 921-5333

**ANNIE K. CARRUTHERS ARCHITECT**

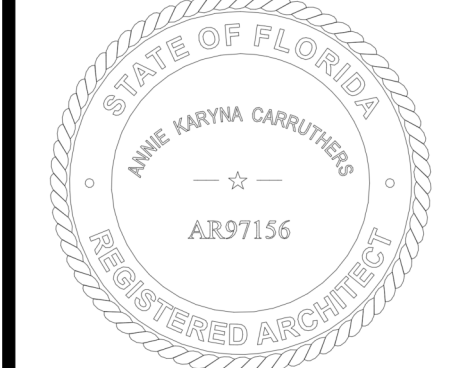

**SEAL**  
 STATE OF FLORIDA LICENSE NO. AR-97156  
 THIS ITEM HAS BEEN DIGITALLY SIGNED AND SEALED BY ANNIE CARRUTHERS, ARCHITECT ON THE DATE ADJACENT TO THE SEAL USING A SHA AUTHENTICATION CODE. PRINTED COPIES OF THIS DOCUMENT ARE NOT CONSIDERED SIGNED AND SEALED AND THE SIGNATURE MUST BE VERIFIED ON ANY ELECTRONIC COPIES.

THESE DESIGNS AND DRAWINGS ARE THE COPYRIGHTED PROPERTY OF IN-SITE DESIGN GROUP, LLC. AND MAY NOT BE REPRODUCED EXCEPT WITH SPECIFIC WRITTEN CONSENT OF THE COMPANY. THE CONTRACTOR MUST CHECK AND VERIFY ALL DIMENSIONS OF THE JOB AND BE RESPONSIBLE FOR SAME. REPORTING ANY DISCREPANCIES TO THE ARCHITECT BEFORE COMMENCEMENT OF WORK. DRAWINGS ARE NOT TO BE SCALED.

**PROJECT NAME:**  
 LUMIÈRE - 7 UNIT RESIDENTIAL CONDO

**PROJECT ADDRESS:**  
 500 HENDRICKS ISLE FORT LAUDERDALE, FL 333301

**DISTRIBUTION:**  
 [SEP.2021] DESIGN DEVELOPMENT APPROVAL

[OCT.22.2021] DEVELOPMENT REVIEW COMMITTEE (DRC) SUBMITTAL

[DEC.14.2021] DRC CASE# UDP-S21050 SITE PLAN LEVEL III

[APR.20.2022] PLANNING & ZONING SITE PLAN LEVEL III APPROVAL CASE# UDP-S21050

**PERMIT SET FOR CONSTRUCTION**

**DATE OF ISSUE:**  
 10/13/2023

**SHEET NAME:**  
 4TH FLOOR PLAN

**SHEET NUMBER:**  
 A-113

**2 SLAB NOTES**

- COORDINATED STRUCTURAL ELEMENTS (COLUMNS AND SHEER WALLS) REFER TO STRUCTURAL DRAWINGS FOR LATEST DIMENSIONS AND LOCATIONS.
- INTERIOR PARTITION - 5/8" GYP BOARD BOTH SIDES ON 3-5/8" MTL 25 GA. STUDS @ 16" O.C. (U.O.N.)
- 6" INTERIOR PARTITION W/SOUND ATTENUATION STC-46. SEE DETAIL WT-1A DETAIL 1 SHEET A-502
- 5/8" GYP BOARD ON GALV 1 1/2" MTL CHANNELS ON 8" C.M.U. WALL THICKNESS PER PLAN. STUCCO EXTERIOR AS NOTED ON PLANS. EXT WALL SHALL BE INSULATED AS MECHANICAL CALCS. SEE STRUCT DWGS FOR FILLED CELL LOCATION

SEE LIFE SAFETY PLAN FOR WALL TYPE AND FIRE RATINGS

**3 WALL TYPE LEGEND**

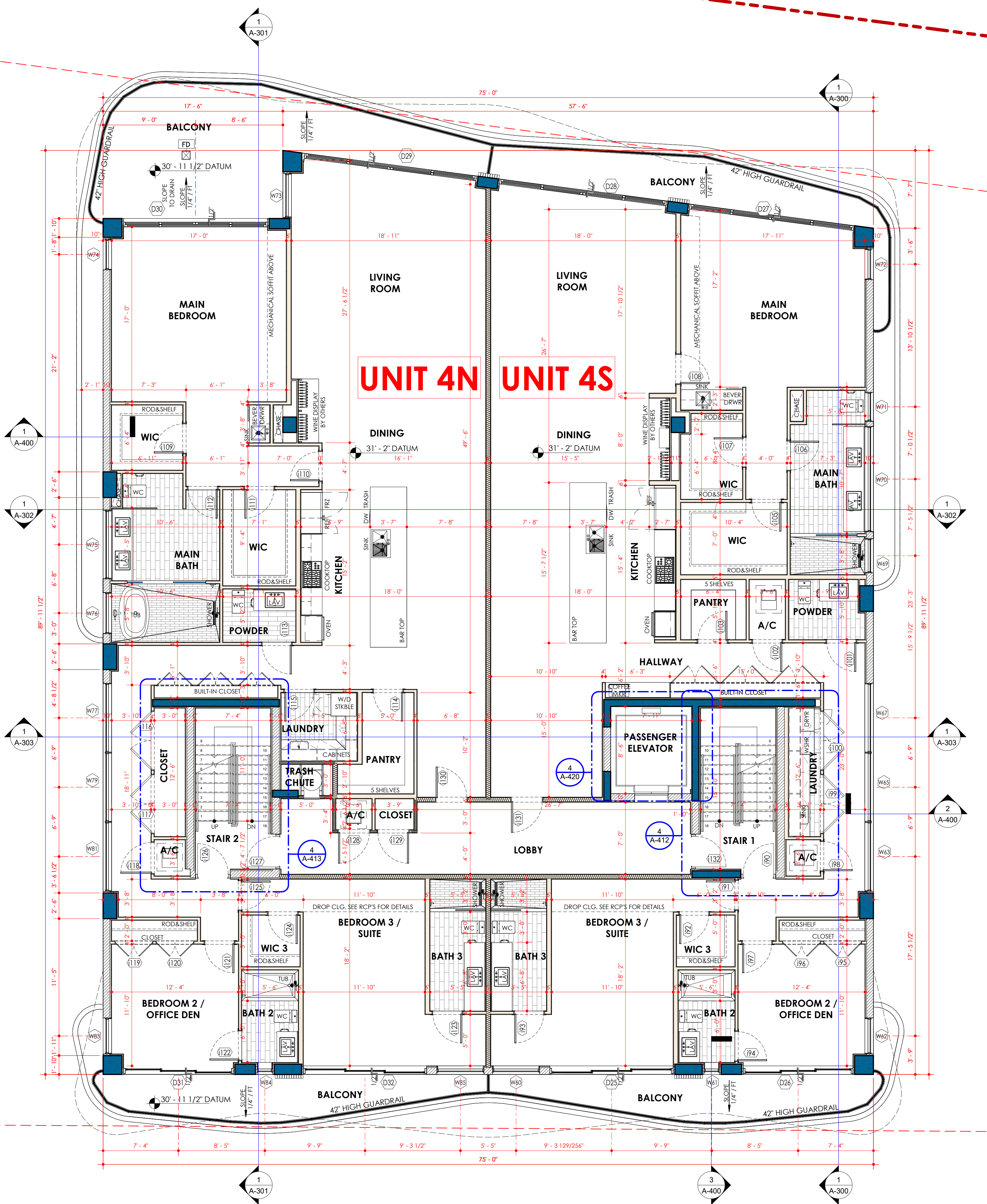

**UNIT 4N UNIT 4S**

